

BKB City Park 5K

Denver, Colorado
 USA T&F Certificate: CO-08009-DP
 Expires December 31, 2018



Start/Finish: Center of manhole cover 90°E of LP 35/57 (pole is on S side of road. Marked on S edge of road.)
1 Mile: 33' N of N manhole cover in middle of road.
2 Mile: Eastbound, 2' E of 8" water covers in street, 11" W of sidewalk/curb junction.
Turnaround: 34' E of LP 56/26
3 Mile: 28 yards W of LP 29/45. Also 7' E of manhole cover which is north of Steele St.

RaceMeasure has measured this course following USA T&F guidelines, and stands by the certification.

However, *RaceMeasure* does not set out the course on race-day, and is not responsible for courses not set out precisely according to this map.

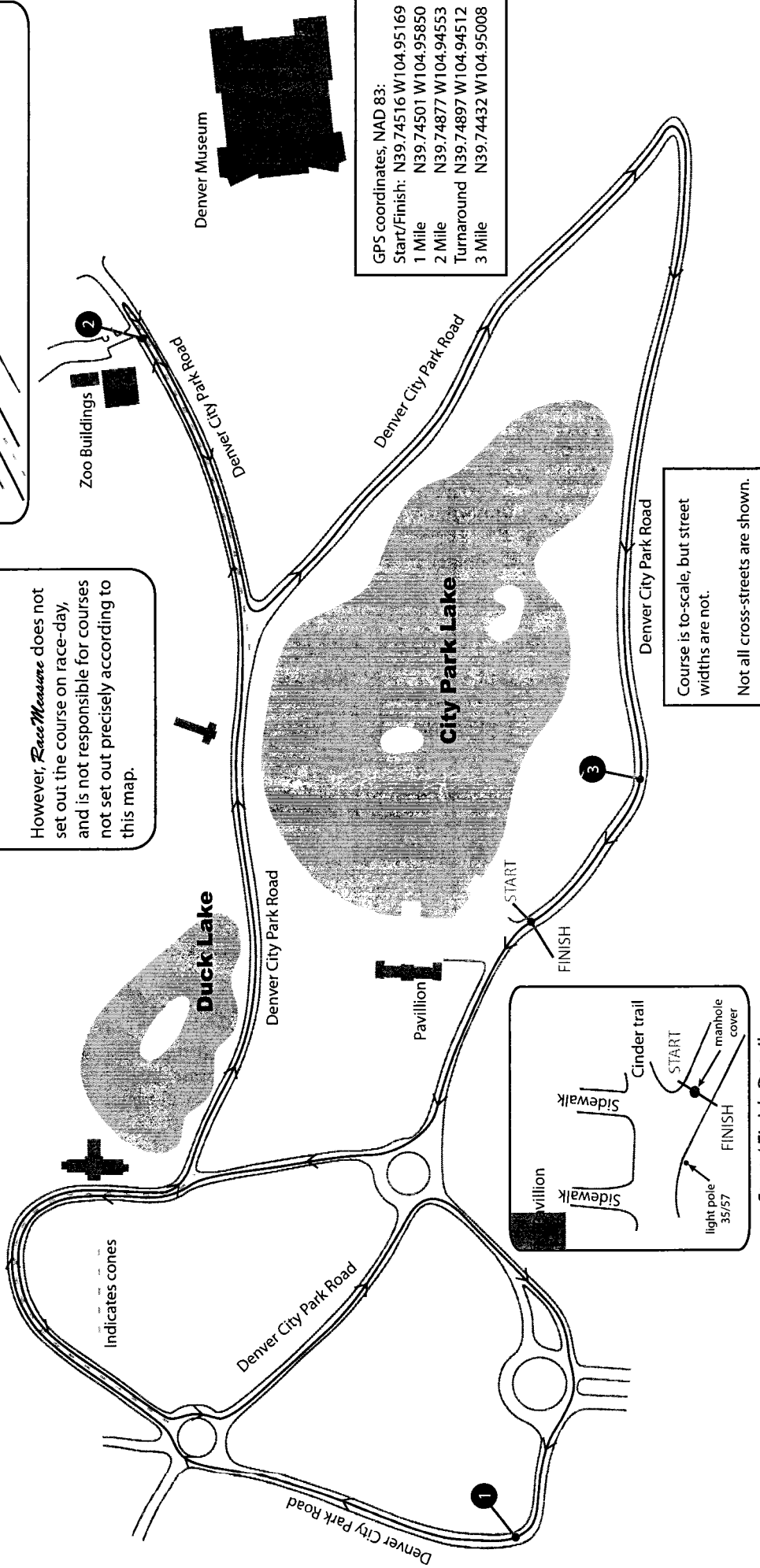
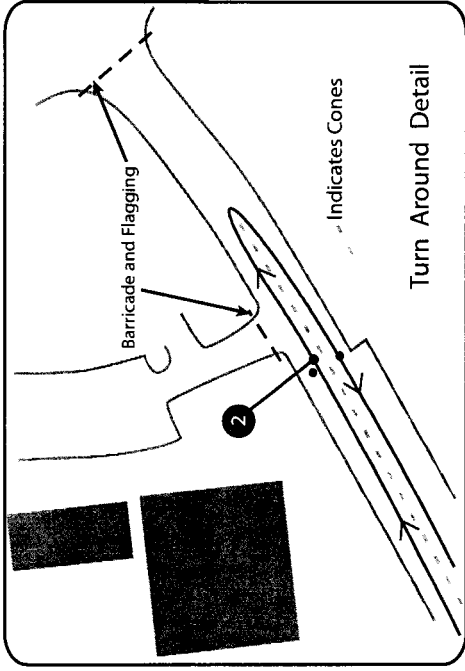

GPS coordinates, NAD 83:

Start/Finish:	N39.74516 W104.95169
1 Mile	N39.74501 W104.95850
2 Mile	N39.74877 W104.94553
Turnaround	N39.74897 W104.94512
3 Mile	N39.74432 W104.95008

Course is to-scale, but street widths are not.
 Not all cross-streets are shown.

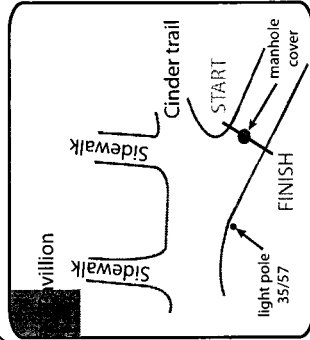

¹ This is basically a flat course. Most elevation variations are from GPS noise. There is only a 50' difference between high and low points. Measurement, map, and elevation profile by RaceMeasure, March 2008. www.RaceMeasure.com